

SC-TWF4

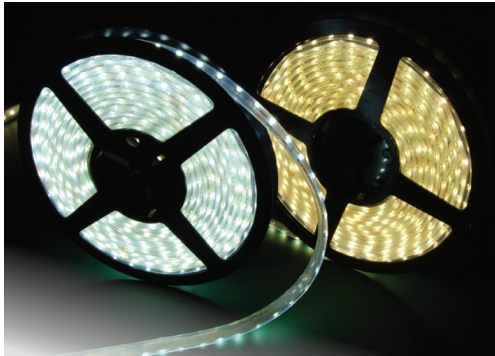

Features

- ※ Flexible enough to be bent at any angles
- ※ Totally waterproof, IP65
- ※ Designed for free cutting every 3 LEDs
- ※ User can use DIY accessories for easy connection of cutting sections
- ※ UV resistant, suitable for outdoor application
- ※ Much brighter than normal rope light

Application

- ※ Cove lighting
- ※ Architectural lights for canopy, corridor, window, archway
- ※ Backlight or edge lighting for signage
- ※ DIY lights for home use
- ※ Path and contour marking
- ※ Decorative lights for holiday, event, show, exhibition

Great advantages

- ※ Eco friendly
- ※ Long life span, standard warranty 3 years
- ※ Complete cut / connection accessories
- ※ No need of constant-current power feed
- ※ Low power consumption
- ※ Custom packing



Technical parameters

Model Number	Color	Length (m)	LED Q'ty	LED Type	Light Output (lumen/m)	Beam Angle (degrees)	Voltage (V DC)	Current (Amps/m)	Max. Power Consumption (W/m)	Continuous Connection (m)
SC-TWF4-W	White	5	300	1210/PLCC -2 SMD Top LED	400	120	12	0.4	4.8	10
SC-TWF4-WW	Warm White	5	300		380	120	12	0.4	4.8	10
SC-TWF4-R	Red	5	300		140	120	12	0.4	4.8	10
SC-TWF4-G	Green	5	300		210	120	12	0.4	4.8	10
SC-TWF4-B	Blue	5	300		40	120	12	0.4	4.8	10
SC-TWF4-Y	Yellow	5	300		160	120	12	0.4	4.8	10
SC-TWF4-RGB	RGB	5	150	Top SMD LED 5050	190	120	12	0.6	7.2	10
SC-TWF4-RGB2	RGB	5	300		300	120	12	1.2	14.4	5
SC-TWF4-W2	White	5	600	1210/PLCC -2 SMD Top LED	830	120	12	0.8	9.6	5
SC-TWF4-WW2	Warm White	5	600		780	120	12	0.8	9.6	5
SC-TWF4-R2	Red	5	600		220	120	12	0.8	9.6	5
SC-TWF4-G2	Green	5	600		240	120	12	0.8	9.6	5
SC-TWF4-B2	Blue	5	600		100	120	12	0.8	9.6	5
SC-TWF4-Y2	Yellow	5	600		240	120	12	0.8	9.6	5

Dimension&Circuit drawings

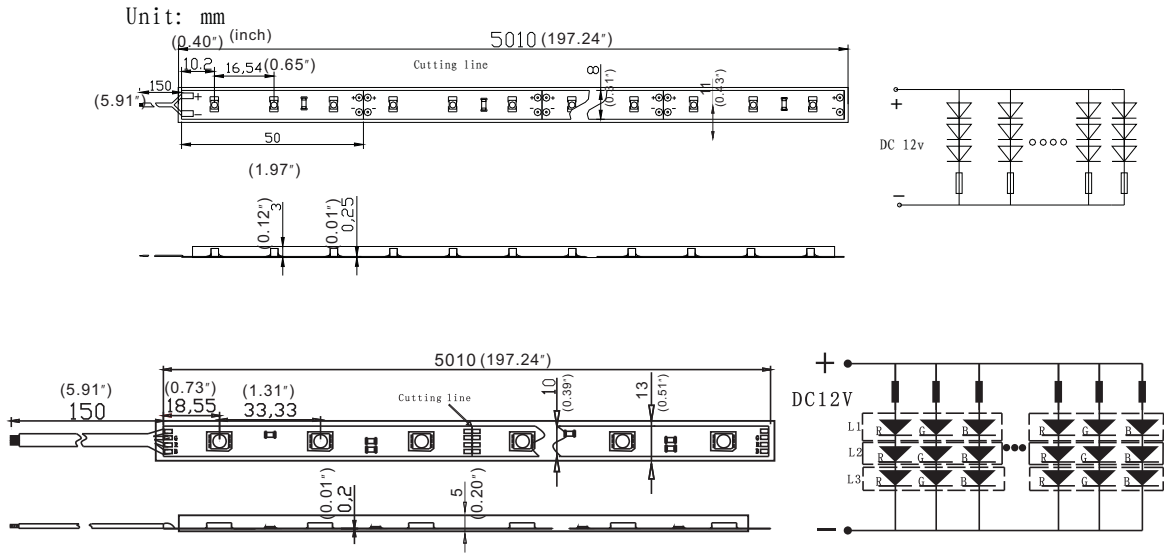

Linking operation

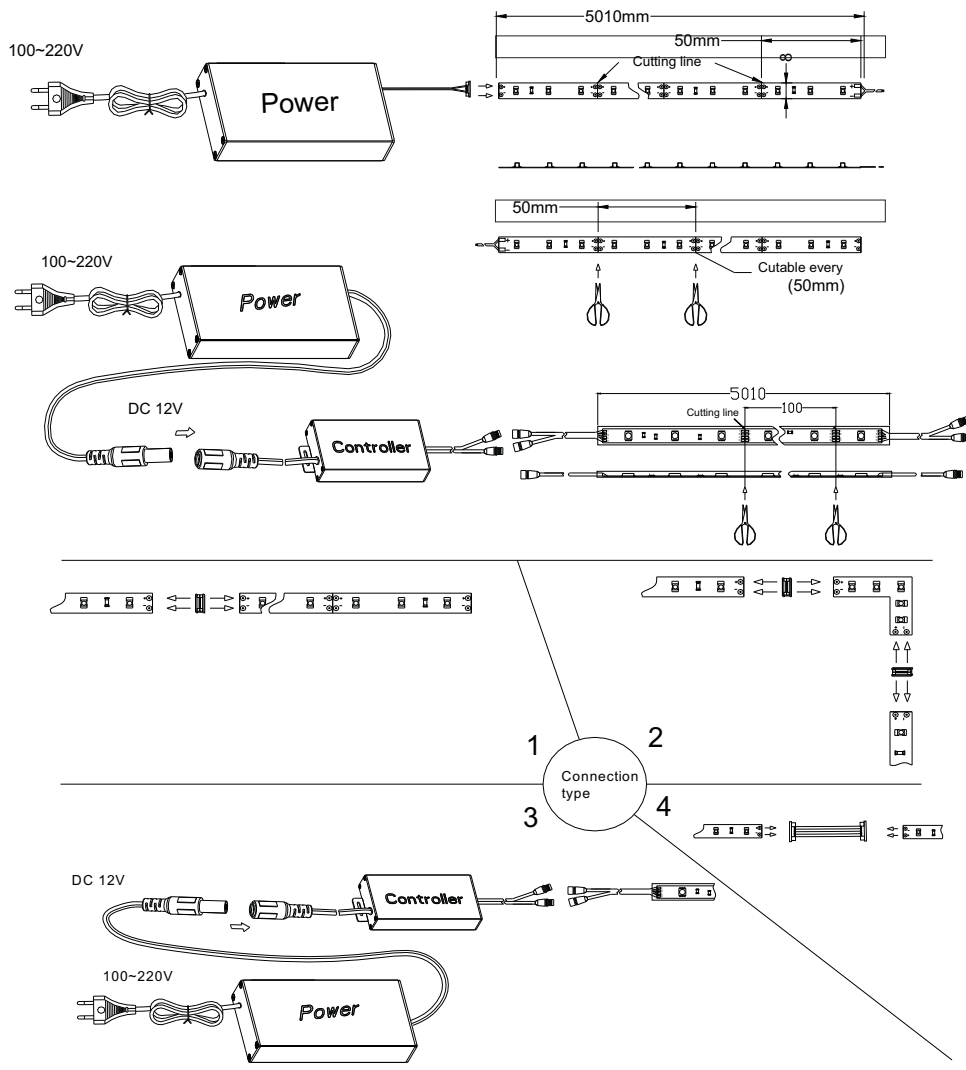

Safety Information

- The strip itself and all its components may not be mechanically stressed.
- Assembly must not damage or destroy conducting paths on the circuit board.
- Installation of LED ribbon (with power supplies) needs to be made with regard to all applicable electrical and safety standards. Only qualified personnel should be allowed to perform installations.
- Correct electrical polarity needs to be observed. Wrong polarity may destroy the strip.
- Parallel connection is highly recommended as safe electrical operation mode.
- Serial connection is not recommended. Unbalanced voltage drop can cause hazardous overload and damage the strip.
- Please ensure that the power supply is of adapters power to operate the total load.
- When mounting on metallic or otherwise conductive surfaces, there needs to be an electrical isolation points between strip and the mounting surface.
- Pay attention to standard ESD precautions when installing the strip.
- Damaged by corrosion will not be honored as a materials defect claim.

It is the user's responsibility to provide suitable protection against corrosive agents such as moisture and condensation and other harmful elements.

Installation

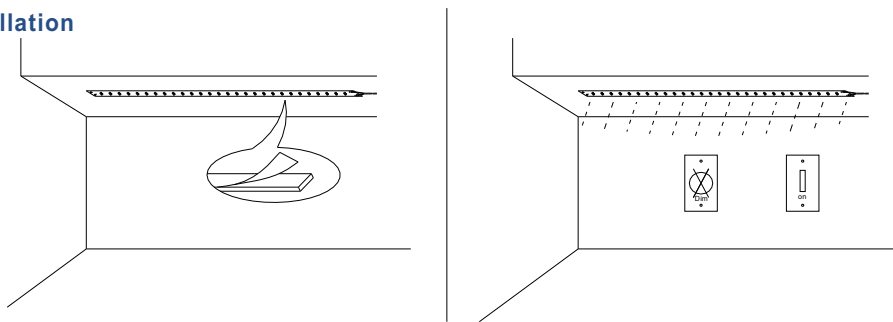

※ Packing information

